

# Pro-face

for the best interface

**SCIENCE GATE**  
Your Automation Partner



SCIGATE AUTOMATION (S) PTE LTD

No.1 Bukit Batok Street 22 #01-01 Singapore 659592

Tel: (65) 6561 0488

Fax: (65) 6562 0588

Email: sales@scigate.com.sg

Web: www.scigate.com.sg

Business Hours: Monday - Friday 8.30am - 6.15pm

USB Solutions

# EZ SERIES

## New Efficiency

Benefit from the flexible and user friendly solution



### Operational Efficiency

We offer a range of devices featuring the latest technology, which let you efficiently add operation, data input, user access control and machine status.



### Engineering Efficiency

USB accessories are tightly integrated into the software to improve engineering efficiency. The single cable architecture further reduces installation time and eases installation at any location.



# Improve machine operation and simplify engineering with a range of USB solutions.

## Customize machine status

Display machine status via the EZ Tower Light without changing PLC system or programming

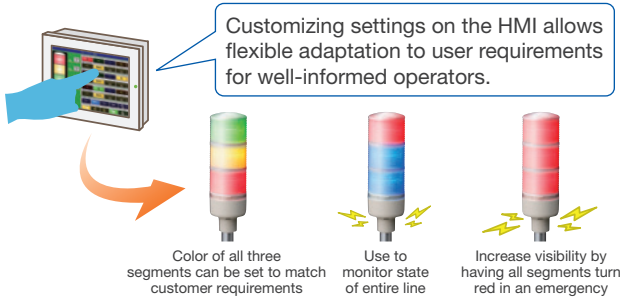

### EZ Tower Light



Select color (red/green/blue/yellow) and flashing settings independently for each light segment. Four different buzzer patterns give the user more information.

## Compact, flexible function switches

Tactile feedback with bright visual status information provides a clear confirmation for any operation. Full integration into the GP-Pro EX software allows consistent operation and labeling.

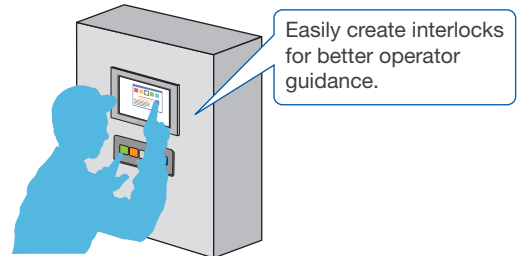

### EZ Illuminated Switch



This single set of pushbuttons contains 5 switches with 6-color LEDs. Mechanical pushbuttons give tactile feedback, and can be mounted vertically or horizontally.

## Responsive data input and operation

Repetitive data input, operation in harsh environments, or operation wearing gloves is difficult and reduces screen lifetime. The EZ Numpad gives tactile feedback to the operator and reduces screen abrasion.

Compare data during input operation to reduce mistakes.

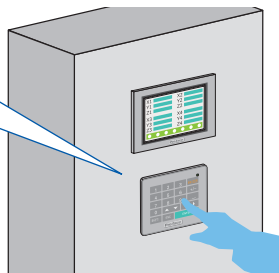

### EZ Numpad



Convenient GP-Pro EX settings reduce engineering. Conveniently save time with automatic switching between data input and function keys.

## Secure user authentication

Protect your know-how and prevent accidental operation with the EZ Fingerprint Recognition Unit access control. Eliminate password sharing and increase security with biometric identification.

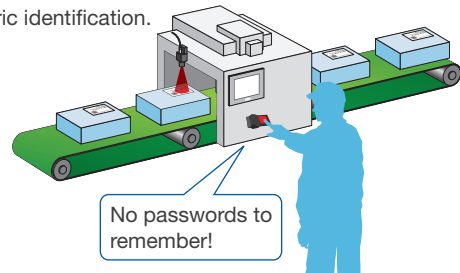

### EZ Fingerprint Recognition Unit



This tough industrial device is configured via dedicated S/W or directly on the HMI. In addition, encrypted data can be backed-up to a PC.

For detailed information, visit our website. <http://www.proface.com/product/other/ez.html>



- For printing purposes, the colors in this catalog may differ from those of the actual unit.
- Actual user screens may differ from the screens shown here.
- Electric equipment should be installed, operated, serviced, and maintained only by qualified personnel. No responsibility is assumed by Digital for any consequences arising out of the use of this material.
- All product names used in this catalog are the registered trademarks or trademarks of their respective companies.
- All information contained in this catalog is subject to change without notice.

**Pro-face**  
for the best interface

Visit our website for more information.  
<http://www.proface.com>

**Global Headquarters**  
Digital Electronics Corporation  
[JAPAN] Tel: +81-(0)6-6613-1101  
[AUSTRALIA] Tel: +61 (0)3 9550 7396  
[DENMARK] Tel: +45 70 22 01 22  
[GERMANY] Tel: +49 (0)212 258 260  
[ITALY] Tel: +39 0362 59 96 1  
[SOUTH KOREA] Tel: +82-(0)2-2630-9850  
[SWITZERLAND] Tel: +41 (0)43 343 7272  
[SINGAPORE] Tel: +65-6832-5533

**North/South American Headquarters**  
Pro-face America, Inc.  
[U.S.A.] Tel: +1-734-477-0600  
[AUSTRIA] Tel: +43 7236 3343 620  
[ENGLAND] Tel: +44 (0)2476 511288  
[INDIA] Tel: +91 80 4333 3540  
[POLAND] Tel: +48 22 465 66 62  
[SPAIN] Tel: +34 (0)93 846 07 45  
[TAIWAN] Tel: +886-(0)2-2657-1121

**European Headquarters**  
Pro-face Europe B.V.  
[THE NETHERLANDS] Tel: +31 (0)23 55 44 099  
[CHINA] Tel: +86-(0)21-6361-5175  
[FRANCE] Tel: +33 (0)1 60 21 22 91  
[INDONESIA] Tel: +62-021-7504419  
[RUSSIA] Tel: +7 (812)336 47 06  
[SWEDEN] Tel: +46 46 540 90 70  
[THAILAND] Tel: +66-(0)2-617-5678